

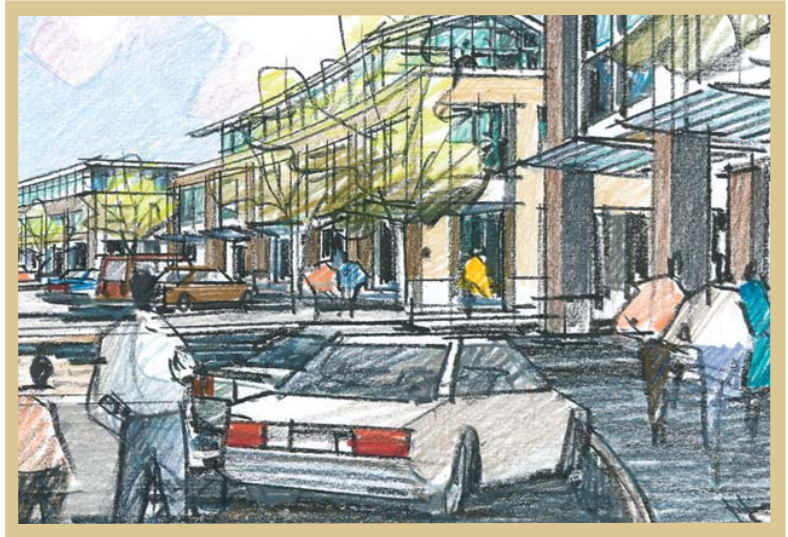

Small town charm.
Big city style.

Demographics of Village of Ponderosa

Village of Ponderosa, set to open early Fall 2007, is the perfect place for business. Carefully controlled and managed so only a well-rounded mix of businesses come in, the overall design maximizes storefront exposure, accessibility and community. It also provides ample parking that is conveniently placed and aesthetically designed. Located in the middle of one of the country's fastest growing residential areas, businesses at Village of Ponderosa are ensured a stable labor force as well as a desirable customer base with high levels of income and education.



DEMOGRAPHIC INFORMATION

	1 Mile Radius* May 15, 2006	5 Mile Radius* May 15, 2006	10 Mile Radius* June 7, 2006	20 Mile Radius* June 7, 2006	Central IA Counties** June 22, 2006
2006 Est. Population	7,072	80,505	281,314	476,026	2005 Total Est. Population: 722,140
2011 Projected Population	8,779	88,884	296,971	507,855	2010 Projected Population: 757,341
2006 Est. Average Household Income	\$109,904	\$89,284	\$72,216	\$69,280	2005 Est. Average Household Income: \$61,709
2006 Est. Median Age	33.09	35.49	36.05	36.06	2005 Est. Disposable Household Income: \$43,297

Average Daily Traffic Count for Mills Civic Parkway: 35,800 • Average Daily Traffic Count for I-35: 63,500

*Information obtained from Claritas, Inc. (800) 234-5973.

** Information on Central Iowa Counties was obtained from The Greater Des Moines Partnership. Central Iowa Counties include Boone County, Dallas County, Jasper County, Madison County, Marion County, Marshall County, Polk County, Story County and Warren County.



village of
ponderosa

Small town charm. Big city style.